

Nearest star system to our solar system





Overview

The closest system is Alpha Centauri, with Proxima Centauri as the closest star in that system, at 4.2465 light-years from Earth. The brightest, most massive and most luminous object among those 131 is Sirius A, which is also the brightest star in Earth's night sky; its white dwarf companion Sirius B is the hottest object.

This list covers all known , , , and within 20 (6.13) of the . So far, 131 such objects have been found. Only to be visible without a.

Over long periods of time, the slow independent motion of stars change in both relative position and in their distance from the observer. This can cause other currently distant stars to.

- , • . Archived from on October 30, 2005. Retrieved October 24, 2005. • Nemiroff, R.;

The easiest way to determine stellar distance to the Sun for objects at these distances is , which measures how much stars appear to.

• • • • •

Why is Proxima the closest star to the Sun?

That's because it's part of the Alpha Centauri system, the closest star system to our sun. Alpha Centauri consists of three known stars (including Proxima). Of the three, Proxima is closest, at 4.2 light-years away. Alpha Centauri appears as the 3rd-brightest star in Earth's sky. But Proxima is too faint to see with the eye.

Which star system contains Proxima Centauri?

Alpha Centauri, triple star system that contains Proxima Centauri, the closest star to the Sun, about 4.2 light-years distant. The system is the third brightest star in the sky. The nearest extrasolar planets are the three planets that orbit Proxima Centauri.

Which star system is closest to Earth?



The closest star system to the Earth is the famous Alpha Centauri group. Located in the constellation of Centaurus (The Centaur), at a distance of 4.3 light-years, this system is made up of the binary formed by the stars Alpha Centauri A and Alpha Centauri B, plus the faint red dwarf Alpha Centauri C, also known as Proxima Centauri.

Which star is closest to Earth?

The closest system is Alpha Centauri, with Proxima Centauri as the closest star in that system, at 4.2465 light-years from Earth. The brightest, most massive and most luminous object among those 131 is Sirius A, which is also the brightest star in Earth's night sky; its white dwarf companion Sirius B is the hottest object among them.

Which star is closest to Alpha Centauri?

Alpha Centauri consists of three known stars (including Proxima). Of the three, Proxima is closest, at 4.2 light-years away. Alpha Centauri appears as the 3rd-brightest star in Earth's sky. But Proxima is too faint to see with the eye. It's a small, dim, low-mass star, with its own planetary system.

What type of star orbits Proxima Centauri?

They orbit with Proxima Centauri as a triple star system. Alpha Centauri A is a Class G star that is 1.1 times the mass of the Sun. Alpha Centauri B is slightly cooler Class K star that is 0.9 times the mass of the Sun. Proxima Centauri, the closest star to the Sun, is a much smaller and cooler star, called a red dwarf.



Nearest star system to our solar system



Alpha Centauri System - Closest Stars to Our Solar System

Exploring Alpha Centauri: The Closest Star System to Our Solar System Introduction to Alpha Centauri Alpha Centauri is the closest star system to us, located about 4.37 light years away from Earth. This amazing system has three stars: Alpha Centauri A, Alpha

What is the nearest star to our solar system?

Flexi Says: Alpha Centauri is at 4.37 light-years from the Sun. Alpha Centauri is the closest star system and closest planetary system to Earth's Solar System. The Alpha Centauri system contains three stars, one binary star system and a third, small star that is



Will we ever reach Alpha Centauri, our closest ...

The closest star, Proxima Centauri, also hosts an exoplanet that scientists believe could have the conditions necessary for life. But reaching this star system would be no small feat. NASA

Scientists Have Calculated How Long It'll Take to Reach Distant Stars

They've broken through barrier that protects our solar system and are now zipping through the Pioneer 10 will swing within .231 parsecs the star system HIP 117795 in the Cassiopeia



Closest known flyby of star to our solar system

Closest known flyby of star to our solar system: Dim star passed through Oort Cloud 70,000 years ago Date: February 17, 2015 Source: University of Rochester Summary: Astronomers from the US



Proxima Centauri

Proxima Centauri is the nearest star to Earth after the Sun, located 4.25 light-years away in the southern constellation of Centaurus. This object was discovered in 1915 by Robert Innes is a small, low-mass star, too faint to be seen with ...



Proxima Centauri, the closest star to our sun

Alpha Centauri is a triple star system located just over four light years, or about 25 trillion miles, from Earth. While this is a large distance in terrestrial terms, it is three times ...





[Explore the 10 nearest stars . Astronomy](#)

If you want to study the stars, there's no better place to start than close to home. After all, the nearest star is just 93 million miles (150 million kilometers) away: the Sun. Its daily



Cosmic Distances

Astronomical units are a useful measure for distances in our solar system, while light years are more practical for distances to the stars. The nearest star system, Alpha Centauri, is seen from Saturn in this image from NASA's Cassini spacecraft. Credit: NASA/JPL

How Far is the Closest Star? , The Sun's Nearest Neighbor

The simple answer is that the Sun is the closest star to Earth, about 93 million miles away. But that might not answer your question. Outside of our Sun, our system's nearest neighbor is Alpha Centauri. This isn't a single star, it's actually a triple-star system

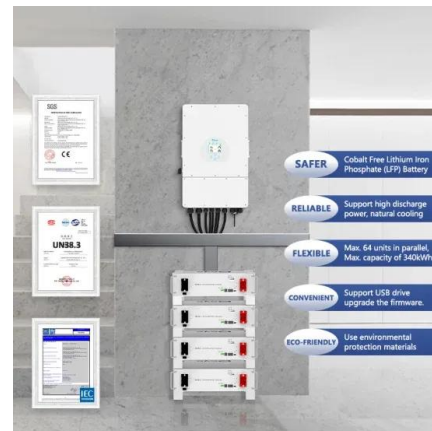

. centauri, the nearest star system to our solar system ...

Answers for . centauri, the nearest star system to our solar system crossword clue, 5 letters. Search for crossword clues found in the Daily Celebrity, NY Times, Daily Mirror, Telegraph and major publications. Find clues for . centauri, the nearest star system to our solar system or most any crossword answer or clues for crossword answers.





New planet detected around Proxima Centauri, closest star our solar system

Astronomers have found evidence of another planet orbiting Proxima Centauri, the closest star to our Solar System. This candidate planet is the third detected in the system and the lightest yet



List of nearest exoplanets

There are 7,026 known exoplanets, or planets outside the Solar System that orbit a star, as of July 24, 2024; only a small fraction of these are located in the vicinity of the Solar System. [3] Within 10 parsecs (32.6 light-years), there are 106 exoplanets listed as confirmed by the NASA Exoplanet Archive .

Alpha Centauri: Facts about the stars next door , Space

Alpha Centauri is a star system with components 4.2 to 4.4 light-years from Earth and comprises three stars. It is the closest star system to the solar system, and one of its stars

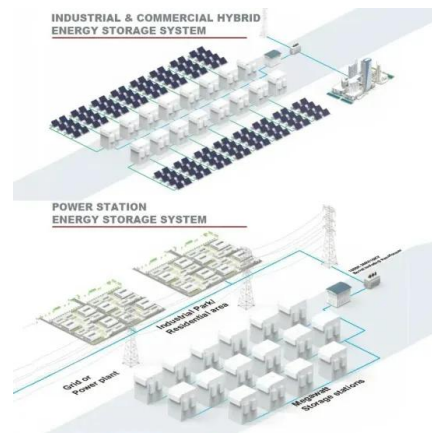

Hubble's Best Image of Alpha Centauri A and B

The closest star system to the Earth is the famous Alpha Centauri group. Located in the constellation of Centaurus (The Centaur), at a distance of 4.3 light-years, this system is made up of the binary formed by the stars Alpha ...



The 10 Closest Stars to Earth

Günay Mutlu/Photographer's Choice RF/Getty Images So, what's the closest star to us? Obviously, the top titleholder on this list is the central star of our solar system: the Sun. Yes, it's a star and a very nice one at that. Astronomers call it a yellow dwarf star, and it



The Closest Known Flyby of a Star to Our Solar System

A newly published study from the University of Rochester details the closest known flyby of a star to our solar system - a dim star that passed through the Oort Cloud 70,000 years ago. A group of astronomers from the US, Europe, Chile, and South Africa have determined that 70,000 years ago a rece

The 44 Closest Stars and How They Compare to our Sun

Our closest neighboring stars are all part of the same solar system: Alpha Centauri. This triple star system - consisting of Proxima Centauri, Alpha Centauri A, and Alpha Centauri B - attracts a lot of interest because it hosts planets, including one ...



TAX FREE

ENERGY STORAGE SYSTEM

Product Model
HJ-ESS-215A(100KW/215KWh)
HJ-ESS-115A(50KW 115KWh)

Dimensions
1600*1280*2200mm
1600*1200*2000mm

Rated Battery Capacity
215KWH/115KWH

Battery Cooling Method
Air Cooled/Liquid Cooled



Stars closest to our solar system

This star, smaller and less luminous than our Sun, stands out as one of the closest known stars to our solar system. Visible to the naked eye, Lalande 21185 is notable for its proximity to the



Alpha Centauri: Star System, Distance, Planets, Location, ...

Alpha Centauri (? Cen) is a triple star system located in the constellation Centaurus is the nearest star system to the Sun and the third brightest point of light in the sky outside the solar system, after Sirius and Canopus outshines the northern luminaries Arcturus, Vega and Capella..



[What is the closest solar system to earth?](#)

The closest star system to our Solar System is Alpha Centauri, which is a triple star system located about 4.37 light-years away from us. It consists of three stars: Alpha Centauri A, Alpha



Hubble's New Shot of Proxima Centauri, our Nearest Neighbor

Shining brightly in this Hubble image is our closest stellar neighbor: Proxima Centauri. Proxima Centauri lies in the constellation of Centaurus (The Centaur), just over four light-years from Earth. Although it looks bright through the eye of Hubble, as you might expect from the nearest star to the Solar System, Proxima Centauri is not visible [...]



[NASA SVS , Alpha Centauri Stellar System](#)

At 4.3 light-years away, Alpha Centauri A and B are the nearest Sun-like stars to our solar system. They orbit with Proxima Centauri as a triple star system. Alpha Centauri A is a Class G star that is 1.1 times the mass of the Sun. Alpha Centauri B is slightly cooler Class K star that is 0.9 times the mass of the Sun. Proxima Centauri, the closest star to the Sun, is a much ...





The 10 Closest Stars to Earth , New Space Economy

Let's take a look at the top 10 stars nearest to Earth and explore what we know about their planetary systems. 1. Sun At just 8 light minutes away, the Sun is by far the closest star to Earth. As the center of our solar system, the Sun's energy is essential for life



Alpha Centauri , Distance, Planets, & Facts , Britannica

Ask the Chatbot a Question Ask the Chatbot a Question Alpha Centauri, triple star system, the faintest component of which, Proxima Centauri, is the closest star to the Sun, about 4.2 light-years distant. The two brighter ...

Planet Found in Nearest Star System to Earth , ESO

Alpha Centauri is one of the brightest stars in the southern skies and is the nearest stellar system to our Solar System -- only 4.3 light-years away. It is actually a triple star -- a system consisting of two stars similar to ...



[NASA SVS , Alpha Centauri Stellar System](#)

At 4.3 light-years away, Alpha Centauri A and B are the nearest Sun-like stars to our solar system. They orbit with Proxima Centauri as a triple star system. Alpha Centauri A is a Class G star that is 1.1 times the mass of ...





The nearest star system , NASA Jet Propulsion Laboratory (JPL)

NASA's Jet Propulsion Laboratory, the leading center for robotic exploration of the solar system. Alpha Centauri is the nearest star system. Distance from Earth 4,365 al (40 000 billion kilometers. The Sun (yellow star) distance from Earth 150 000 000 km, the



Alpha Centauri , Distance, Planets, & Facts , Britannica

Alpha Centauri, triple star system that contains Proxima Centauri, the closest star to the Sun, about 4.2 light-years distant. The system is the third brightest star in the sky. The nearest extrasolar planets are the three ...

Meet Alpha Centauri

It's an M-type red dwarf star, and much, much dimmer than the Sun. Astronomers have found a planet orbiting this star, making it the nearest planet to our own solar system 's called Proxima Centauri b and it's a rocky world, just as Earth is.



Which is the nearest star from our Solar system?

Q. The nearest star to our solar system is 4.29 light years away. How much is this distance in terms of parsecs? How much parallax would this star (named Alpha Centauri) show when viewed from two locations of the Earth six months apart in its orbit around the



The nearest star outside our solar system is approximately 4×10^{13}

The nearest star outside our solar system is approximately 4×10^{13} kilometers (km) from Earth and our moon is approximately 380,000 km from Earth. If these distances were scaled down so that the distance from Earth to our moon was represented by 1 in



New planet detected around star closest to the Sun , ESO

A team of astronomers using the European Southern Observatory's Very Large Telescope (ESO's VLT) in Chile have found evidence of another planet orbiting Proxima Centauri, the closest star to our Solar System. This candidate planet is the third detected in the system and the lightest yet discovered orbiting this star. At just a quarter of Earth's mass, the planet is also ...

Contact Us

For catalog requests, pricing, or partnerships, please visit:
<https://www.vdbconstruction.co.za>