

What planet is close to the moon right now





Overview

From October 28 to November 3, the Moon will visit the constellations Leo, Virgo, Libra, and Scorpio. This week, the brightest dot near the Moon will be Mercury (mag -0.3). The most prominent star near our natural satellite will be Spica (mag 1.0) from Virgo. As the New Moon occurs this week (on November 1), the lunar.

In this article, you'll come across several types of celestial events. They all involve the relative positions of the Moon and celestial objects and occur close together in time. However, they.

*The percentage of Moon illumination is for London. To find out the Moon illumination percentage for your location, check the lunar calendar.

About 45 minutes after sunset on Monday, look toward the southwest horizon to see Venus hovering near to the moon; an eye-catching tableau in spite of the pair's low altitude. Which planets will be visible on November 17 & 20?

On November 17, the 98%-illuminated Moon and Jupiter (mag -2.8) will meet in the constellation Taurus. The planet will rise in the evening and will be visible to the naked eye. On November 20, the 77%-illuminated Moon and Mars (mag 0.2) will meet in the constellation Cancer. The planet will rise in the evening and will be visible to the naked eye.

When can you see the Moon & Mars?

October 20 - The Moon rises near Jupiter, with the giant planet looking extremely bright. You should be able to find them low in the east after around 10 pm. October 23-24 - Early risers will be able to spot Mars together with the Moon, high overhead in the south both mornings.

Is a bright object near the Moon a star or a planet?

A bright object near the Moon can be a star or a planet. You can tell the difference by checking if the object twinkles. If it does, then it's a star; if not, it's a planet. Also, Jupiter and Venus (sometimes Mars and Saturn, too) are way brighter than most stars.



Will Uranus & the full moon meet on November 15?

On November 15, the Full Moon and Uranus (mag 5.7) will meet in the constellation Taurus. The bright Pleiades star cluster will also shine nearby. The planet will appear in the sky in the evening. Note that Uranus is rather faint to be observed without any optical aid, so it's best to bring a pair of binoculars.

How do I view planets and stars near our natural satellite?

To view the planets and stars near our natural satellite, choose a cloudless night and use Star Walk 2 or Sky Tonight to learn when the celestial objects are best placed for your location. For a visual explanation, watch our recently released video on how to identify bright objects near the Moon using the Sky Tonight app, step by step.

Where can I find a full moon on October 20th?

On the 13th and 14th after dark, look for the nearly full Moon with Saturn toward the southeast. Then on the evening of October 20th, the Moon rises near Jupiter, with the giant planet looking extremely bright. You should be able to find them low in the east after around 10 pm that night.



What planet is close to the moon right now



[What Planet Is Next to the Moon Tonight](#)

On October 25, 2022, at 08:00 GMT (4:00 a.m. EDT), three hours before the solar eclipse, the New Moon will come close to Venus and occult it. Both objects will be in the constellation Virgo. The planet will be right next to the Sun and, therefore, unobservable.

Moon Phase for Today , Current Moon Cycle for Today and Tonight

Moon Phase for Sunday Nov 3rd, 2024 The current moon phase for today is the Waxing Crescent phase. On this day, the moon is 1.62 days old and 3.18% illuminated with a tilt of 148.209 . The approximate distance from Earth to the moon is 399,891.98 km



Current Night Sky

Now a look at Moon and planet pair-ups for October. On the 13th and 14th after dark, look for the nearly full Moon with Saturn toward the southeast. Then on the evening of October 20th, the Moon rises near Jupiter, with the giant planet looking extremely bright.

Night sky for tonight -- what to look for in this evening's sky , Space

Find out what you can see in the night sky for tonight, from planets and stars to dazzling meteor showers. Jam packed issues filled with the latest cutting-edge research, technology and theories



- Voltage range: 691.2-947.2V
- >6000 cycles (100% DOD)
- Rated battery capacity: 216KWh (customizable)
- EMS communication: 4G/CAN/RS485

Night Sky Map & Planets Visible Tonight in North East

Our Interactive Night Sky Map simulates the sky above North East. The Moon and planets have been enlarged slightly for clarity. On mobile devices, tap to steer the map by pointing your device at the sky. Mercury rise and set in North East Fairly close to the Sun

Night Sky Map & Planets Visible Tonight in Dallas

Our Interactive Night Sky Map simulates the sky above Dallas. The Moon and planets have been enlarged slightly for clarity. On mobile devices, tap to steer the map by pointing your device at the sky. Mercury rise and set in Dallas Fairly close to the Sun. Visible only



Planets in the Sky Tonight , Discover Which Planets You Can ...

Planets Visible Tonight. Discover the planets that are currently visible in the night sky. Learn about their positions, rise and set times, and how to spot them from your location. Whether ...





Which planet is closest to Earth? (Hint: There's more than 1 right)

Which planet is closest to Earth right now? For this question, the answer can be either Mercury, Venus or Mars, depending on where each planet is on its orbital path compared to Earth. For example

114KWh ESS



Mercury Is Right Next to the Moon Tonight: How to See It

It's been one exciting year for folks who like to gaze into the night sky, and we've still got a few more months to go before the end of 2024. To close out August, we'll have a planet parade

Our Solar System

Our solar system is made up of a star--the Sun--eight planets, 146 moons, a bunch of comets, asteroids and space rocks, ice, and several dwarf planets, such as Pluto. The eight planets are Mercury, Venus, Earth, Mars, Jupiter, Saturn, Uranus, and Neptune.



[Find Out What Planets Are Visible Tonight](#)

The interactive tool displays sunrise and sunset times, morning and evening twilight times, moonrise and moonset times, the Moon's phase, a list of naked-eye planets visible in the evening and morning skies, rise and set ...





What's that bright star near the Moon?

Here is a list of dates when the Moon may be seen close to a bright planet or star. 2021 April 2: Antares April 6: Saturn April 7: Jupiter April 15: Aldebaran April 17: Mars April 20: Pollux April 22-23: Regulus April 26: Spica ...



Moon

Moon, or Luna in Latin, is planet Earth's one and only natural satellite and the brightest object in the night sky. With a diameter of 2,159.2 miles (or 3,474 km), it is roughly the size of the African continent and is the largest ...

Moon, Jupiter, Saturn 2021 , What Planet Is Visible Next To The Moon

On December 9, 2021, at 06:10 GMT (1:10 a.m. EST), the Moon will get close to another gas giant, Jupiter, passing 4 28' to the planet's south. The Moon will be shining at a magnitude of -11.5, and Jupiter will have a magnitude of -2.3. Look for the two objects in

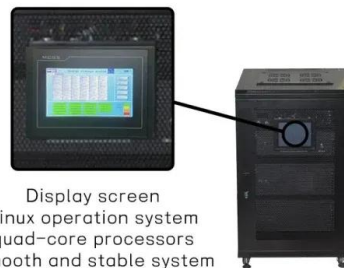

Night Sky Map & Planets Visible Tonight in Oregon

Our Interactive Night Sky Map simulates the sky above Oregon. The Moon and planets have been enlarged slightly for clarity. On mobile devices, tap to steer the map by pointing your device at the sky. Mercury rise and set in Oregon Fairly close to the Sun. Visible



Planets Visible Tonight in June 2024 , Complete Guide for

Planets Visible Tonight - November 2024 The month of November lets us see all of the planets except Mercury, which is too close to the sun for us to spy. Venus, Jupiter and Saturn are all evening planets, along with the ice worlds of Uranus and Neptune. Mars begins the month firmly as a morning planet but moves to allow decent late evening viewing as December comes into ...



[Saturn Next to the Moon Tonight](#)

Tonight, Saturn will saddle right up to the moon--and you might be able to see the spectacular pairing from your backyard. After 10 p.m. local time, the moon will be nearly full and Saturn will

Visible Planets

The Moon will be to the right of Jupiter on November 16 and to the left of Jupiter on November 17. November 22: Venus passes about one degree north of Nunki, a second-magnitude star in Sagittarius. Look southwest beginning at 5-6 p.m. local time.



Night Sky Map & Planets Visible Tonight in Great Britain

Our Interactive Night Sky Map simulates the sky above Great Britain. The Moon and planets have been enlarged slightly for clarity. On mobile devices, tap to steer the map by pointing your device at the sky. Mercury rise and set in Great Britain Fairly close to the



What planet is near the moon in the night sky tonight?

4 ???· The moon will meet Mercury on the evening of November 3, Venus on the evening of November 4, Saturn on the evening of November 10, Uranus on the evening of November 15, ...



Use the moon to find Uranus in the night sky tonight , Space

A bright moon will help point the way towards Uranus on Friday (Jan. 19). The blue-green planet will be located just below and to the right of the 8-day-old moon.

Night Sky Map & Planets Visible Tonight in Texas

Our Interactive Night Sky Map simulates the sky above Texas. The Moon and planets have been enlarged slightly for clarity. On mobile devices, tap to steer the map by pointing your device at the sky. Mercury rise and set in Texas Fairly ...

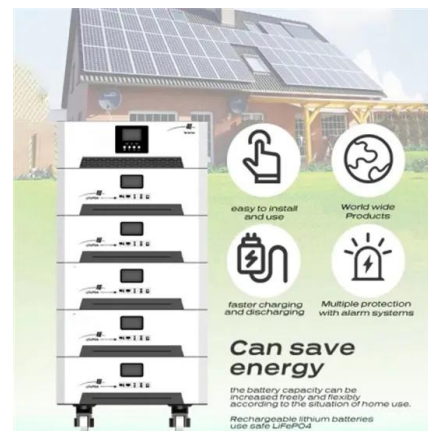

Visible planets and night sky guide for November

2 ???· The moon will hang close to Mercury on November 3, and it'll float close to Venus on November 4. Venus will continue to ascend and become a dazzling evening star through the end of the year.



What planet is closest to the moon?

From a planet of mass $16 M$ and radius $4 R$, we wish to send an object to its moon of mass M and radius R . Distance between centres of planet and moon is $10 R$. Minimum speed at which object should be projected from the surface of planet so that it reaches moon is (Assume that the planet and the moon are at rest)



What planet is closest to the moon right now

Final answer: The closest planet to the moon at any given time largely depends on the orbits of the earth and other planets. But most of the time, the planet closest to the Moon is Earth. However, if we consider other planets, it's either Venus or Mars. Explanation:



Night sky, November 2024: What you can see tonight [maps]

Find out what's up in your night sky during November 2024 and how to see it in this Space stargazing guide. Monthly skywatching information is provided to Space by Chris Vaughan of Starry

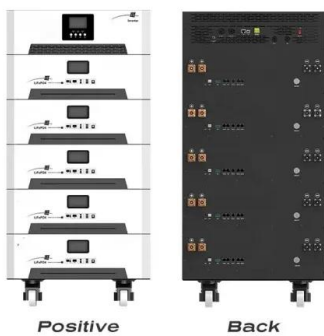

Night Sky Map & Planets Visible Tonight in Calgary

Our Interactive Night Sky Map simulates the sky above Calgary. The Moon and planets have been enlarged slightly for clarity. On mobile devices, tap to steer the map by pointing your device at the sky. Mars rise and set in Calgary View in the early morning. Mars can



Today's Moon Phase , Current moon cycle for today and tonight

Moon Phase for today: Nov 05, 2024 The Moon's current phase for today and tonight is a Waxing Crescent Phase. Best seen in the west after the sun dips below the horizon at sunset. This is the first Phase after the New Moon and is a great time to see the features of the moon's surface.



Current Night Sky , Center for Astrophysics , Harvard ...

October 20 - The Moon rises near Jupiter, with the giant planet looking extremely bright. You should be able to find them low in the east after around 10 pm. October 23-24 - Early risers will be able to spot Mars together with the Moon, ...

Contact Us

For catalog requests, pricing, or partnerships, please visit:
<https://www.vdbconstruction.co.za>