

Whether the wind resistance is on or off after the generator sounds





Overview

How to reduce noise output from a wind turbine?

The most promising single feature to reduce the noise output from a wind turbine is serrated trailing edges (STE) . Most of the noise from a wind turbine is trailing edge noise and can be reduced to by adding STE's on the blades serrated trailing edges.

What are the characteristics of wind turbine noise?

AM due to trailing edge noise directivity The most important feature of wind turbine noise is trailing edge noise. It has a cardioid directivity pattern characterized by a highest noise emission direction pointing toward the leading edge of the aerofoil/blade .

Why does a wind turbine sound like a swoosh?

Subjectively, people describe noise from a wind turbine as a 'swoosh', similar to the sound of waves on the seashore. The precise frequency content of the noise at any particular location is influenced by factors such as the wind turbine model, wind speed, the listener's distance from the turbine (s), and the surrounding terrain.

Should wind turbine noise be revisited?

The research indicates that these should be revisited in view of advancements in onshore wind turbine technology, knowledge and scientific evidence of the potential impact of wind turbine noise, and the evolution of government noise policies in each of the devolved administrations of the UK.

Why do wind turbines have noise limits?

Noise limits are applied to ensure that turbines are located sufficiently far from houses or other noise-sensitive premises to protect the amenity of the location in question. This is a key factor in the design of a wind farm and where turbines can be located. What are the noise limits for wind turbines?



How reliable is wind turbine noise data?

Noise from wind turbines is often a decisive parameter when introducing a wind turbine project and noise data must be reliable. The IEC 61400-11 measurement methods for wind turbine noise emission are the most recognized methods and provide data for siting as well as.



Whether the wind resistance is on or off after the generator sounds



Principle Parameters and Environmental Impacts that Affect ...

The share of wind-based electricity generation is gradually increasing in the world energy market. Wind energy can reduce dependency on fossil fuels, as the result being attributed to a ...

On the optimization of generators for offshore direct drive wind ...

Torque per generator active material cost, (c) the difference between generator active material costs and the wind turbine revenue for 5, 10 and 15 years period of operation and (d) the wind ...



The 5 Best Home Wind Turbines for Clean Energy ...

The Best Home Wind Turbine for Apartment Living; Whether it's a giant wind farm turbine or a home wind turbine, the answer is typically the same: most wind turbines just aren't built sustainably. None of my ...



Firman Generator runs for a few seconds and shuts down

Firman was pretty good about responding to emails. The initial problem was a bad rotor due to the slip ring coming loose. So they sent me a new rotor and stator. I installed ...



Cambridge International Examinations Cambridge International ...

4 Fig. 4.1 shows a small wind-turbine used to generate electricity. Fig. 4.1 The wind-turbine drives an electric generator. The wind blows with a velocity of 7.0 m / s at right angles to the plane of ...



The generalized Maxwell-slip friction model applied to starting of

Starting of small turbines is significantly affected by friction resistance of drivetrains. When the effect of drivetrain is not considered in small turbine design, the rotor ...

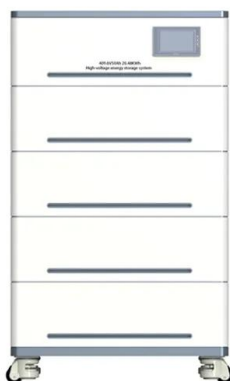

[Wind Turbine on the grill of the car](#)

There will be no wind turbine repairmen at truck stops. A car alternator is cheap and easy to get, but they do not perform well at lower RPM. With an alternator, I would plan for ...



AMPLITUDE MODULATION IN WIND TURBINE NOISE

Two of these are discussed below. 1. AM due to trailing edge noise directivity. The most important feature of wind turbine noise is trailing edge noise. It has a cardioid directivity pattern ...



11 Best Windproof Lighters

The Explorer turns off the plasma after 7 seconds of continuous use. The battery is good for around a week or so of standby time between charges. If you want a ruggedized and weatherproof plasma arc lighter the ...

Why wind generators die young and how to make them work ...

A turbine's resistance to failure decreases with age. But considering the generator a complex system, lets the engineer approach its failure from the concept that ...

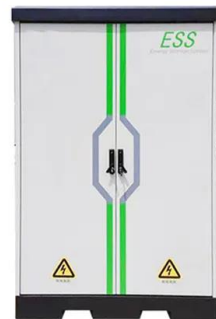

Vertical axis resistance type wind turbines for use in buildings

Within the placing of the proposed wind vitality converter, it can be predicted that with the aid of closing the rotor off at the beat and the foot by way of a disk that tasks over the ...



Five important tests to run on wind turbines , Megger

5. Low resistance testing. Measuring low resistance is an important electrical test because it helps identify components where the resistance has exceeded acceptable ...



Wind & Rain Storm -- Masking Background Noise

The Wind & Rain Storm is one of the sounds that help me cope. Person below me, I get where you're coming from absolutely. Similar problem with focus, similar "I don't think ...

[General windpower information](#)

Long-term off-grid operation is possible, but the system is much more complicated from an electrical perspective and will generally need some form of 'ultimate backup' like a diesel ...



Dump Load and Diversion Loads for Wind Energy Systems

Just to confirm, four 2.0 Ohm resistors in parallel will give a combined resistance of: $1/(2^{-1} + 2^{-1} + 2^{-1} + 2^{-1}) = 0.5$ Ohms. As electrical power is equal to $I^2 * R$, then $27.8^2 \times 0.5 = 386$ watts, and ...





Roof-top Wind Farms: The Symphonic Sounds of a Lifestyle

Combined, the power output is way shy of 2 kw. But, the wind doesn't blow constantly and when it does it is a variable resource. A single wind generator or a small wind ...



The Best Wind Turbines for Off-Grid Energy

3 ???· Factors to ?Evaluate ?Before? Investing in an Off-Grid Wind Turbine; Q& A; In Summary; Top Features to Consider When Choosing a Wind Turbine for Off-Grid Energy. When it comes to harnessing wind power for off-grid energy, ...



WINDEXchange: Wind Turbine Sound

Are Wind Turbine Sounds Noisy or Loud? Most modern [residential](/markets/distributed) (small- to medium-sized) wind turbines create sound that is only slightly above the ambient wind noise ...



- LiFePO₄ Battery,safety*
- Wide temperature: -20~55°C*
- Modular design, easy to expand*
- The heating function is optional*
- Intelligent BMS*
- Cycle Life: > 6000*
- Warranty:10 years*



A state-of-the-art review of the vibration and noise of wind ...

According to the above problems, this paper focuses on wind turbine drivetrains, and reviews the vibration and noise from a systematic perspective of "generation-analysis ...



The Science of Wind Energy: How Turbines Convert Air ...

Explore the science behind wind energy and how wind turbines convert air into electricity. Learn about the environmental benefits and working principles of this clean, renewable energy source. It connects the slow rotation of the rotor to ...



Electrical power of the wind turbine vs. load resistance.

The goal of this study is to investigate the performance of a small horizontal axis wind turbine blade at wind speeds of lower than 5 m/sec numerically and experimentally.

Wind Turbine Dump and Diversion Loads: What They Do and How ...

Wind turbines are designed to be under a load when operating. For a wind turbine, the load is almost always an electrical load which is drawing electricity from the wind ...

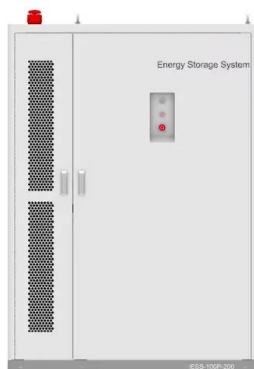

Report for BEIS: A review of noise guidance for onshore wind ...

A systematic review and meta-analysis of evidence on the effects of wind turbine sound exposure on noise annoyance and sleep quality, A more detailed review of national and regional ...



Generator Off Sound Effects

Choose from 581 royalty-free Generator Off sounds, starting at \$2, royalty-free and ready to use in your project. Chat with Pond5 support. Take up to 50% off SFX o Wind Down, Whirring ...



- TELECOM CABINET
- BRAND NEW ORIGINAL
- HIGH-EFFICIENCY

Effect of Load on Power Output.



In many cases there is gearbox between the blades and the generator to increase the RPM at the driveshaft. In this experiment, you will measure the power output of a wind turbine under load ...

The Frequency Regulation Strategy for Grid-Forming Wind ...

The Frequency Regulation Strategy for Grid-Forming Wind Turbine Generator and Energy Storage System Hybrid System in Grid-Connected and Stand-Alone Modes

ESS

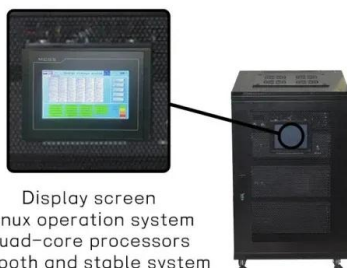

Display screen
Linux operation system
quad-core processors
smooth and stable system

CHAPTER 5 ROTOR RESISTANCE CONTROL OF WIND TURBINE ...

93 5.3.2 Output Power Control The power input to the induction generator (P_m) is $P_m = T_e \cdot \omega_r$ (5.2) A fraction of this power is dissipated in the rotor resistance. The



Harnessing the Wind: A Comprehensive Guide to ...

By harnessing wind energy, the Nature's Generator Powerhouse Wind Turbine provides an independent or supplementary charging solution, ensuring access to power both day and night, making it invaluable for off-grid ...



The Wind Resistance Capabilities of Concrete Roof Tile

Robin Anderson, Technical and Strategy Development Manager, Westlake Royal Roofing Solutions Many regions of the United States, including Florida and the Southeast, are subject ...

A review on wind turbine noise mechanism and de-noising ...

By adding empirical mode decomposition (EMD) and autocorrelation de-noising to the wavelet package transform under the effects of white noise and short-term disturbance ...



Frequently Asked Questions: Wind Turbine Noise

Are wind turbines noisy? Despite the fact that wind turbines generate sound, modern wind turbines are in general much quieter than people anticipate. Conversing normally ...



Compatibility with Wind Generator Charge Controllers

I just bought a SmartSolar MPPT 150/35 to run six solar panels. I also have a wind generator. I did have a non-branded Chinese hybrid controller but its internal limits would ...



[6.4: The Physics of a Wind Turbine](#)

Then, how much power can be captured from the wind? This question has been answered in a paper published in 1919 by a German physicist Albert Betz who proved that the maximum ...



Contact Us

For catalog requests, pricing, or partnerships, please visit:
<https://www.vdbconstruction.co.za>